

1 FIRST FLOOR PLAN
A-2 1/4"=1'-0"

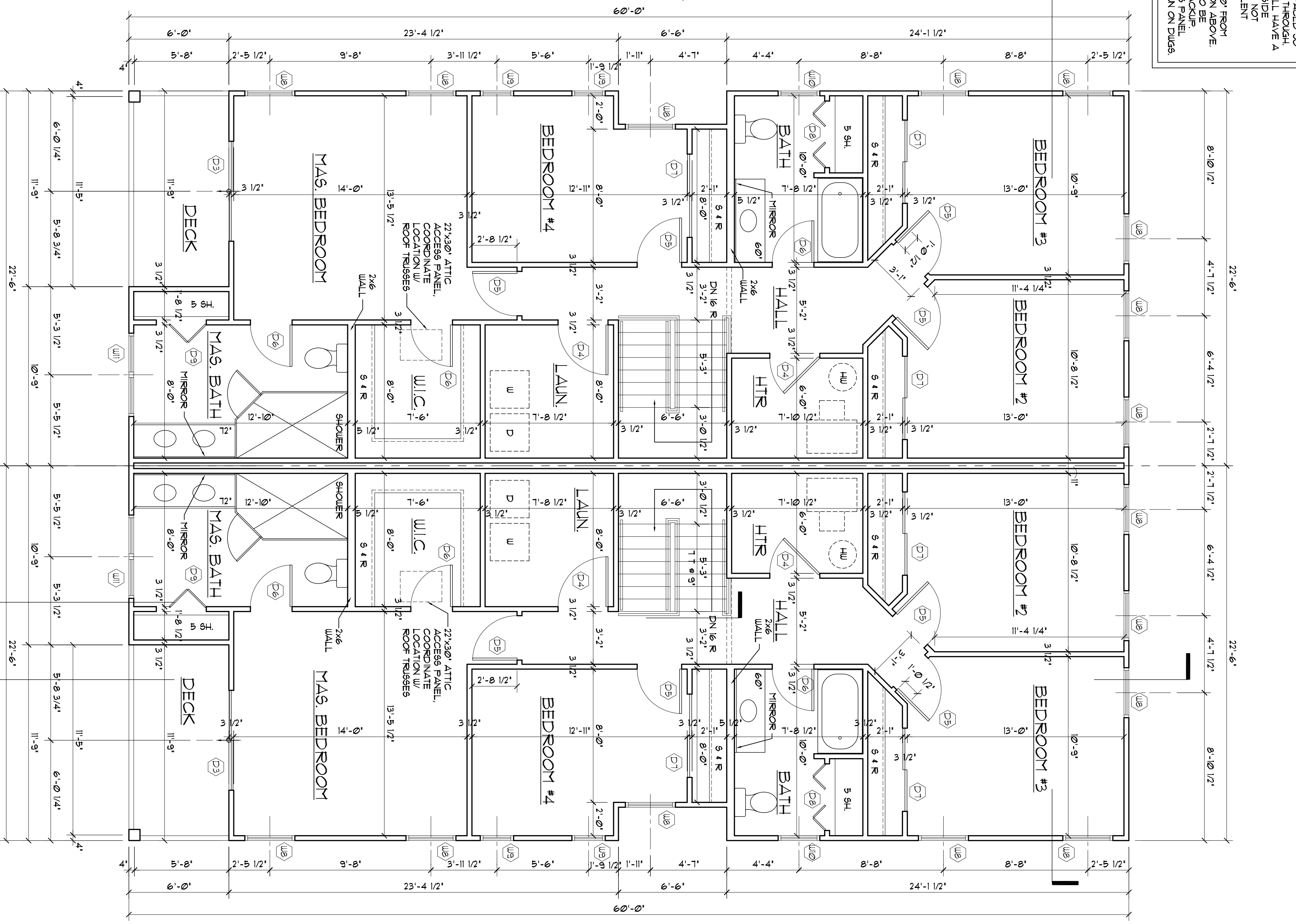

2 SECOND FLOOR PLAN
A-2 1/4"=1'-0"

NOTE:
 1. ALL WALLS TO BE 2x4 W.D. STUDS UNLESS NOTED OTHERWISE.
 2. MAXIMUM RISER 8 1/4". MIN. TREAD 9 1/4".
 3. STAIR HANDRAILS ARE TO BE 34" ABOVE TREAD NOSING W/ BALUSTERS SPACED SO THAT A 4" SPHERE CANNOT PASS THROUGH.
 4. ALL STAIRWAY HANDRAILS SHALL HAVE A MIN. GROSS SECTION WITH AN OUTSIDE DIAMETER OF 1 3/4" AND A MIN. GROSS SECTION WITH 2 3/8" OR EQUIVALENT GRADEABILITY.
 5. MAINTAIN MIN. HEADROOM OF 80" FROM TREAD NOSE TO ANY OBSTRUCTION ABOVE.
 6. ALL SMOKE DETECTORS ARE TO BE INSTALLED IN ALL BEDROOMS AND BATHS.
 7. PROVIDE 22"x20" ATTIC ACCESS PANEL IN CEILING AS REQUIRED/DAS SHOWN ON DLG65.

SHEET TITLE		FIRST & SECOND FLOOR PLANS	
DATE:	6/19/08	SHEET NO.	A-2
PROJ. NO.:	0814	SCALE:	AS NOTED

DESIGNED BY	JG	SEAL	
DRAWN BY	RP		
CHECKED BY	JG		
APPROVED BY	JOSEPH GARRAMONE, R.A.		
DATE	N.J. A108919		

PROPOSED TWO FAMILY DWELLING
 FOR
M. W. MITCHELL, INC.
 108 E. RAMBLER AVE. WILDWOOD CREST, N.J.

GARRAMONE ARCHITECTS, LLC
 ARCHITECTS / PLANNERS

51 GASKO ROAD
 MAYS LANDING, NJ 08330
 (609) 476-2977
 (609) 476-4425 (FAX)

Garramone Architects, LLC expressly reserves its copyright and other property rights to these plans. All designs, specifications and drawings are the property of Garramone Architects, LLC and are to be used only for the project in full or in part without obtaining the expressed written approval and consent of Garramone Architects, LLC. These documents shall not be transferred to any unauthorized third party without the firm's consent.